

Insert 800 VT Turbo PC

référence P968244

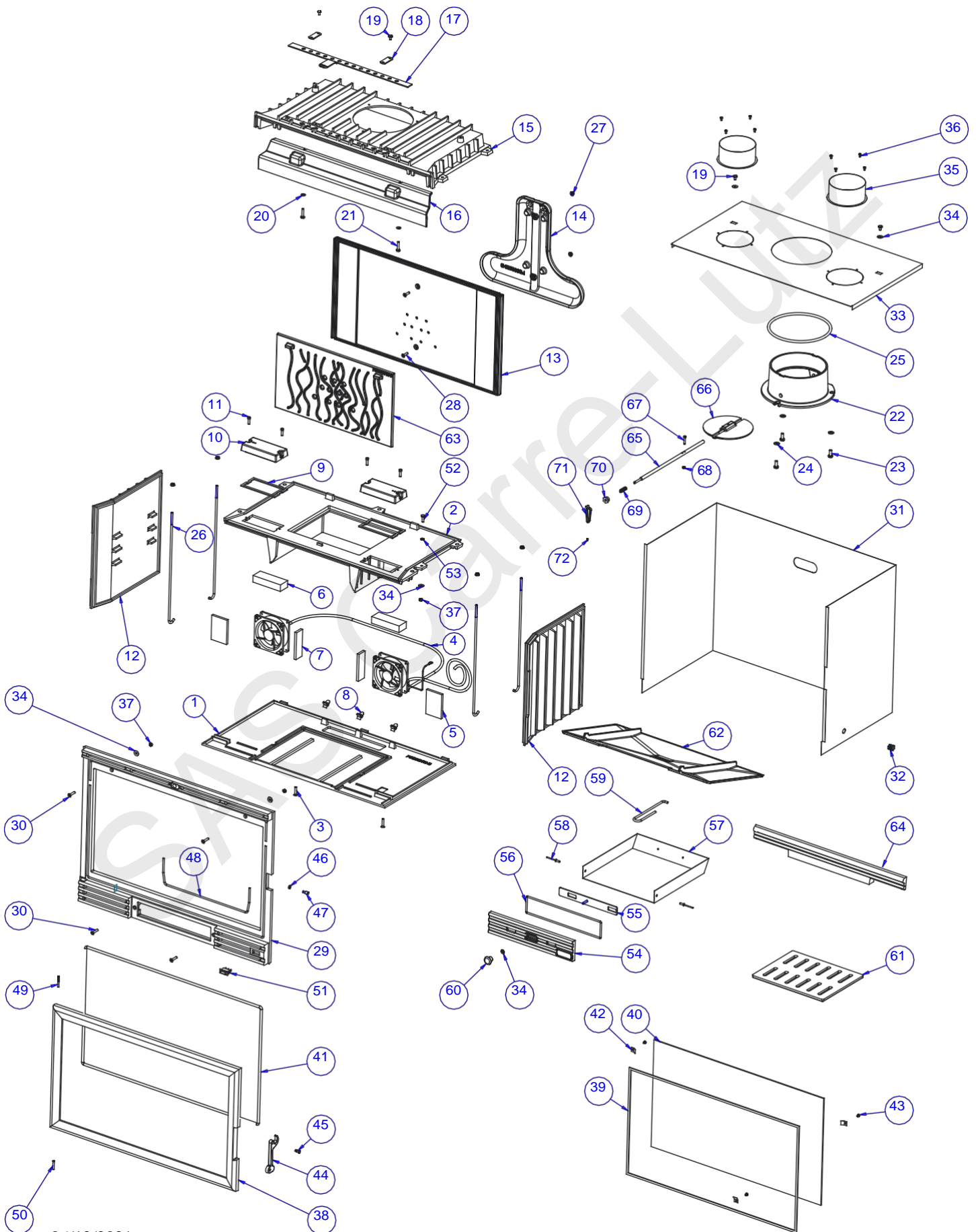

Insert 800 VT Turbo PC

référence P968244

| Rep. | Référence | Désignation | Quantité |
|------|------------|---------------------------------|------------|
| 1 | F680100B-B | Socle | 1 |
| 2 | F680878U | Embase | 1 |
| 3 | AV8636200 | VAM FHC M6X20 BRUT | 2 |
| 4 | AL401201 | Appareillage +2 ventilateurs | 1 |
| 5 | AI719264A | Carton céramique | 2 |
| 6 | AI701542 | Laine céramique | 2 |
| 7 | AI713110A | Carton céramique | 2 |
| 8 | AD162000 | Clips tôle | 3 |
| 9 | AI010080 | Joint 7x3 | 2x 0,50m |
| 10 | F670690B | Capot | 2 |
| 11 | AV8666166 | VAM CHC M06X16 INOX | 4 |
| 12 | F670104B | Coté | 2 |
| 13 | F680350B-B | Fond Postcombustion | 1 |
| 14 | F680152B-B | Collecteur | 1 |
| 15 | F680111U | Avaloir | 1 |
| 16 | F680351B | Guide air | 1 |
| 17 | AT800133B | Registre | 1 |
| 18 | AT610112A | Bride | 2 |
| 19 | AV8406100 | VAM TH M6X10 BRUT | 4 |
| 20 | AV4100060 | Rondelle M M6 BRUT | 2 |
| 21 | AV8406300 | VIS TH 6X30 | 2 |
| 22 | F670164U | Buse | 1 |
| 23 | AV8408200 | VAM TH M8X20 BRUT | 3 |
| 24 | AV4100080 | Rondelle M M8 BRUT | 3 |
| 25 | AI303008 | Joint de buse | long 0.66m |
| 26 | AS700256 | Tirant | 4 |
| 27 | AV7220060 | Ecrou embase M6 | 6 |
| 28 | AV8636250 | VAM FHC M6x25 | 2 |
| 29 | F680130B-B | Façade | 1 |
| 30 | AV8636300 | VAM FHC M6X30 BRUT | 4 |
| 31 | AT800120B | Carcan enveloppe | 1 |
| 32 | AD160000 | Presse étoupe | 1 |
| 33 | AT800121C | Carcan dessus | 1 |
| 34 | AV4110060 | RONDELLE L M6 BRUT | 6 |
| 35 | AT700312 | Manchette D125mm | 2 |
| 36 | AV8614290 | Vis à tôle 4.2x9.5 | 8 |
| 37 | AV7100060 | Ecrou M6 BRUT | 3 |
| 38 | F680112U | Porte | 1 |
| 39 | AI010080 | joint vitre 7x3 | long 2.19m |
| 40 | AX116682A | Vitre GV | 1 |
| 41 | AI303008 | Joint de porte D8 | long 2.36m |
| 42 | AT700312 | Manchette D125mm | 2 |
| 43 | AV8644067 | VAM TCPZ M4X6 ZN | 3 |
| 44 | F670883B | Loquet | 1 |
| 45 | AS800251B | Vis loquet | 1 |
| 46 | AV7130060 | Ecrou bas M6 BRUT | 1 |
| 47 | AS700253B | Axe excentrique | 1 |
| 48 | AI303005 | Joint thermo-corde D5 long.0.6m | 1 |
| 49 | AV6305400 | Goupille-cannelée 5X40 | 1 |
| 50 | AV0105300 | Axe de porte | 1 |
| 51 | AL713301 | Interrupteur 3 positions | 1 |
| 52 | AV8406200 | VAM THC M6X20 BRUT | 1 |
| 53 | AV4150060 | Rondelle éventail D6 | 1 |
| 54 | F680353U | Façade cendrier | 1 |
| 55 | AT800119B | Registre primaire | 1 |
| 56 | AI303005 | Joint de cendrier D5 | long 0.74m |
| 57 | AT800122A | Tôle cendrier | 1 |
| 58 | AV5205160 | Rivet D5x16 | 2 |
| 59 | AS800255 | Main froide | 1 |
| 60 | AS700400A | Bouton chauffage | 1 |
| 61 | F680099B | Grille | 1 |
| 62 | F680358B | Défecteur | 1 |
| 63 | F680354B-B | Taque Invicta | 1 |
| 64 | F680107B | Chenet invicta | 1 |
| 65 | AS700258A | Tige de manoeuvre volet | 1 |
| 66 | F670651B | Volet | 1 |
| 67 | AV8405250 | VAM TH M5X25 BRUT | 1 |
| 68 | AV7100050 | Ecrou M5 | 1 |
| 69 | AS700255 | Ressort tige volet | 1 |
| 70 | AS700292A | Ecrou tige | 1 |
| 71 | F670563U | Bouton volet | 1 |
| 72 | AV8714080 | Vis pointeau M4x8 | 1 |